

## EM320C



### GLASS DOOR COVER PLATE FOR SLIM ARMATURE HOUSING

This cover plate is required to hide the rear of slim armature housings/back plates that have been glued to glass doors. Improves aesthetic appearance from the opposite side of the door.

#### FEATURES

- Surface mount (adhesive required)
- Brushed stainless steel
- For use on glass door
- Suitable for slim maglocks

#### TECHNICAL INFORMATION

- Dimensions: 195mm(L) x 46mm(W) x 3mm(D)
- GDFG adhesive is also required

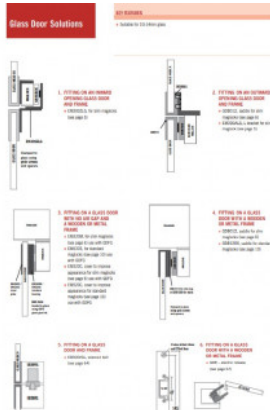

## RELATED PRODUCTS

 <p><b>EM02</b></p>	 <p><b>EM300ABP</b></p>	 <p><b>EM320M</b></p>	 <p><b>GDFG</b></p>
--	--	---	--